

# INSTALLATION INSTRUCTIONS

## Kitchen Faucet W/ Sprayer 廚房龍頭 (附噴槍) 安裝說明

### CAUTION : Prevent The Risk Of Product Damage.

注意：為增加產品使用壽命，請依說明清潔供水管路。

a. Turn the angle stops (water suppliers) on and run for 1 minute before connecting supply hose (flexible hose) to faucet body. or b.

安裝編織管之前，先把供水開關全開排水一分鐘。或 b./

b. Connect and tighten the faucet and angle stops with supply hose (flexible hose) to finish installation, then remove the aerator, fully turn on both hot and cold water run for 1 minute; turn off the water and reinstall the aerator.

把龍頭、供水開關及編織管接好並鎖緊之後，把起泡器移開，把熱水及冷水全部轉開一分鐘，然後把水關掉再把起泡器裝回去。

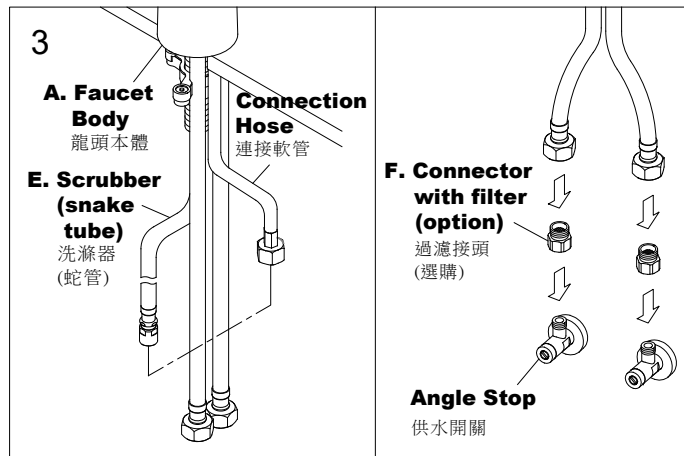
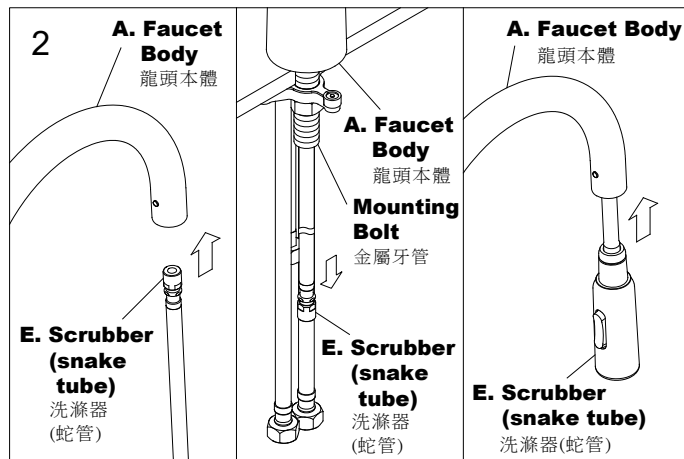
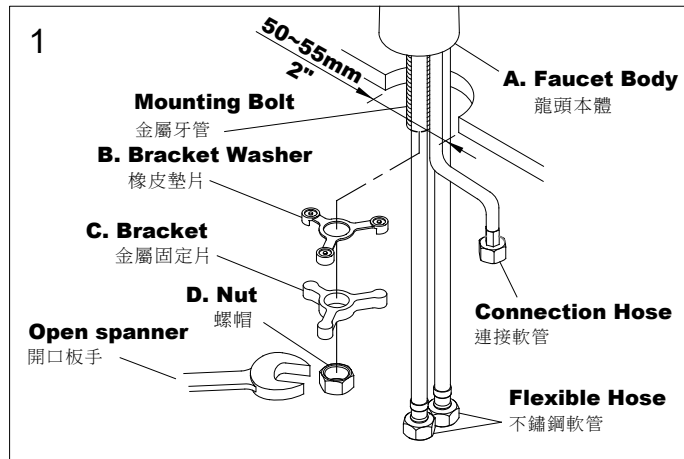

1. Set the **Bracket Washer**, the **Bracket**, and the **Nut** in order after passing the mounting bolt, the **Flexible Hose**, and the **Connection Hose** through the deck hole. After confirming the position, fix the faucet by locking the **Nut** with an **Open spanner**.

將冷熱進水不鏽鋼軟管、連接軟管和金屬牙管穿過洗臉盆(檯)洞口後，從金屬牙管下方依序套入橡皮墊片、金屬固定片和螺帽，確認方向位置後，利用開口扳手鎖緊螺帽固定龍頭。

2. Pass the **Scrubber (snake tube)** through the **Faucet Body** until the **Scrubber (snake tube)** and the **Faucet Body** are snapped into the deck hole.

將洗滌器(蛇管)牙端穿過龍頭本體出水管直到洗滌器端與龍頭本體卡入溝槽。

3. Lock the **Scrubber (snake tube)** with the **Connection Hose**, and lock the flexible hose to the **Angle stop**. 將洗滌器(蛇管)牙端與連接軟管鎖緊，將冷熱進水的不鏽鋼軟管鎖於供水開關。

4. Make sure the **Mounting Bolt** is 250mm (10") above the ground. If yes, go on to Step 5. If not, skip to Step 6. 確認牙管距離地板250mm(10")，如夠250mm(10")，作步驟5，如不夠250mm(10")，作步驟6。

5. Disassemble the **Gravity Ball** with a **Phillips Screwdriver** as shown, and then lock the **Gravity Ball** on the **Scrubber (snake tube)**, 250mm (10") from the **Mounting Bolt**. 如圖將重力球以十字螺絲起子拆解後鎖於洗滌器(蛇管)上距離金屬牙管250mm(10")處。

6. Disassemble the **Gravity ball** with a **Phillips Screwdriver** as shown, and then lock the **Gravity ball** on the **Scrubber (snake tube)**, 200mm (8") from the bottom panel. 如圖將重力球以十字螺絲起子拆解後鎖於洗滌器(蛇管)上距離底板200mm(8")處。

7. Make sure all the fixing points are locked properly, and the installation is completed. 測試水龍頭各接點鎖固處正常即完成安裝。

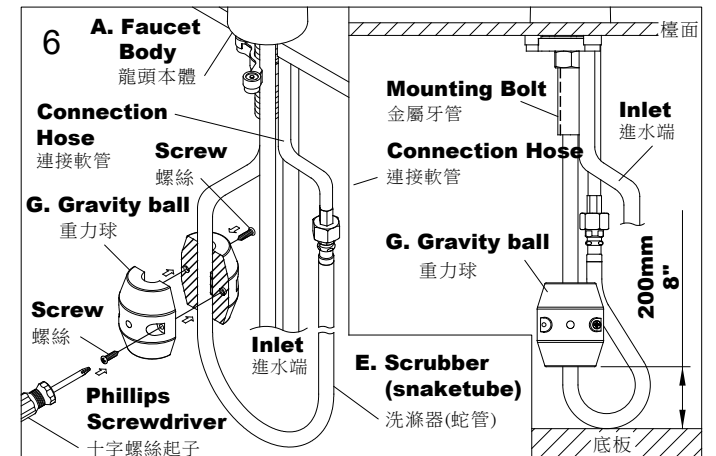
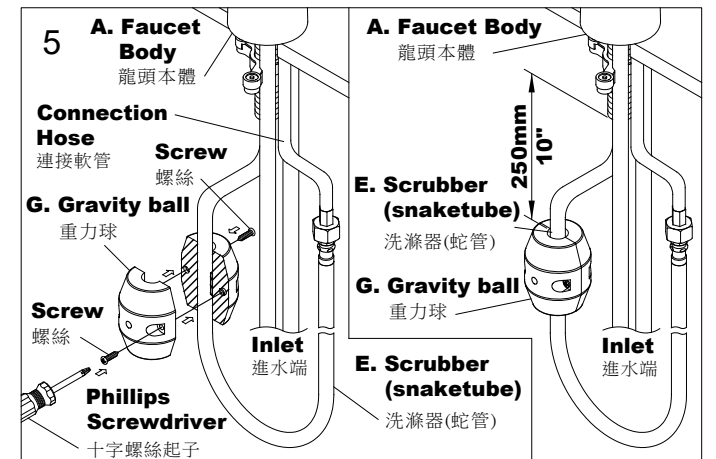
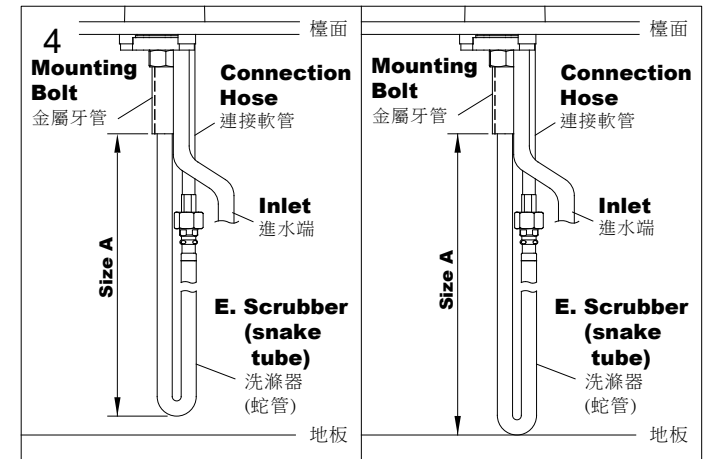

## FIXING CONTENTS

組配件內容

