

Adjustable Shower Holder 7920-9C-80CP

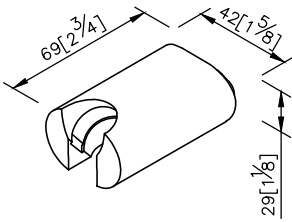

1. Users could adjust the hanging angle for 5 levels, 10 degrees for each level.
2. The body of shower holder is attached with plastic lining, which could keep the shower holder from falling off.
3. Easy installation and the product is without any seam.
4. Past 20,000 cycles lifespan test.
5. Chrome plated finish meets the standard of ASTM-SC2.
6. Main body brass material meets JIS 3604 standard.

unit: mm[inch]

