

Bath Towel Rack
7807-65-80CP

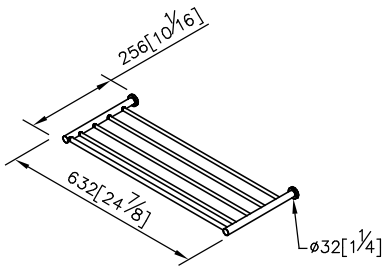

- 1.Brass tube meets JIS C2700 standard.
- 2.Stainless Steel body meets SUS 304 standard.
- 3.Premium metal construction for durability.
- 4.Justime finishes resist corrosion and tarnish.
- 5.Finish meets the standard of ASTM-SC2.
- 6.Vertical force could support a static load of 5 kgf.
- 7.Coordinates with other products in Still One collection.

unit: mm[inch]

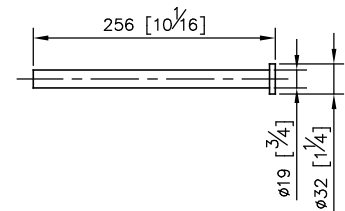
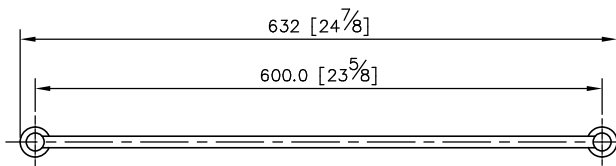
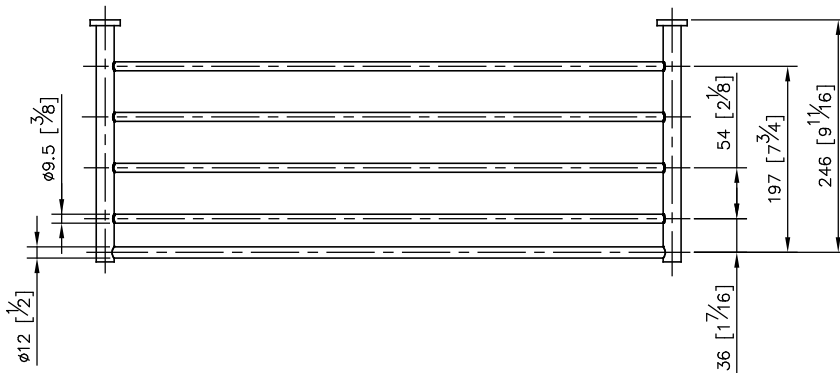

Mounting Template Specification

