

## INSTALLATION INSTRUCTIONS

**Bath / Shower Mixer / Under Body**  
一切三浴缸龍頭及埋壁本體安裝說明

**Applicable Product Number:**  
適用產品型號:

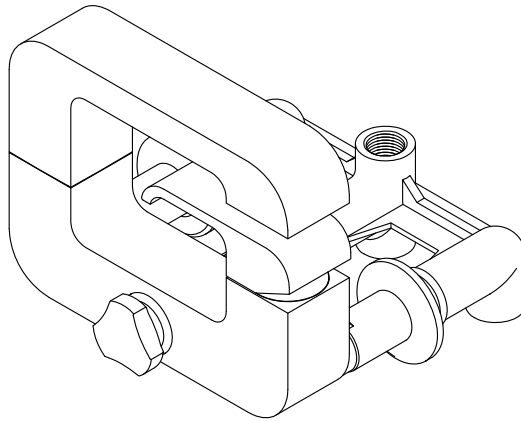

6904-BW-80CP

# CARE & CLEANING

## 清潔與保養

**CAUTION : This product might be damaged by improper installation, acid cleaning solution, misuse, improper care and cleaning.**

1. Always follow the INSTALLATION INSTRUCTIONS provided and use extreme care while installing.
2. Do not use acid cleaning solution or abrasive cleaner (Ex: Hydrochloric acid or toothpaste); test your cleaning solution on an inconspicuous area before applying to the entire surface.
3. Wipe surfaces clean and rinse completely with water immediately after applying cleaner. Do not soak with cleaners. Rinse and dry any overspray that lands on nearby surfaces.
4. Use a dampened sponge or cloth to clean surface. (Do not use abrasive material such as brush or scouring pad. )

注意：此產品有可能因為不當安裝，誤用酸性清潔劑或清潔方式不正確而造成產品受損。

1. 產品安裝時必須依照產品所附的安裝說明和操作方式安裝。
2. 不可使用含有酸性或具研磨效果的清潔劑清洗（例如：鹽酸、牙膏），請先在產品較不顯眼的地方測試您的清潔方法，然後再應用到整個表面。
3. 產品塗佈清潔劑後，應立即擦拭除污，用清水沖洗，並擦乾產品和檯面。切勿讓清潔劑在產品表面浸濕潤漬過久。
4. 請使用濕海綿或乾淨棉布擦拭產品表面。（不可使用會刮傷或具研磨材質的刷子及鋼刷）。

# FIXING CONTENTS

## 組配件內容

### A. Under Body X 1 (with Protect Sleeve, Gasket)

牆壁內本體(含保護套筒，  
墊片)

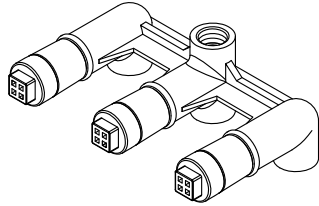

### B. Bath / Shower Mixer

一切三浴缸龍頭

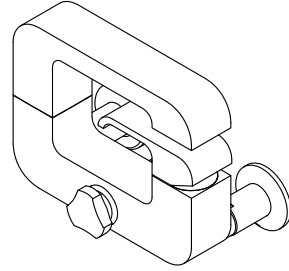

### C. JUSTIME TOOL T001-10-66ZP

JUSTIME專用工具  
T001-10-66ZP

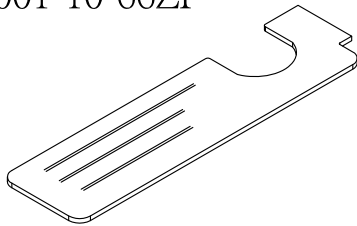

# INSTALLATION NOTE

## 安裝注意事項

**⚠ CAUTION : Please read the following point carefully before Installation.**

1. Keep the **Under Body** faces horizontal and parallel to the wall that will be finished.
2. Connect hot and cold supplies pipes to the **Under Body**, so they are between 2"(5cm) minimum and 3"(7.6cm) maximum from the finished wall.

**⚠ CAUTION : Risk of product damage.**

1. When finished installation, turn the valve on and run water for 1 minute to remove any debris before using.

**⚠ 注意：安裝前，請詳閱下列注意事項。**

1. 本產品安裝固定閥體於牆壁內側時，閥體需使用水平儀確定與牆壁保持平行。
2. 進水管中心與最終完成牆面的距離須保持在最小2"(5cm)到最大3"(7.6cm)之間。

**⚠ 注意：為增加產品使用壽命，請依說明清潔供水管路。**

1. 完成安裝後，需在使用前先把供水開關全開排水持續一分鐘，去除雜質，以保持管路清潔。

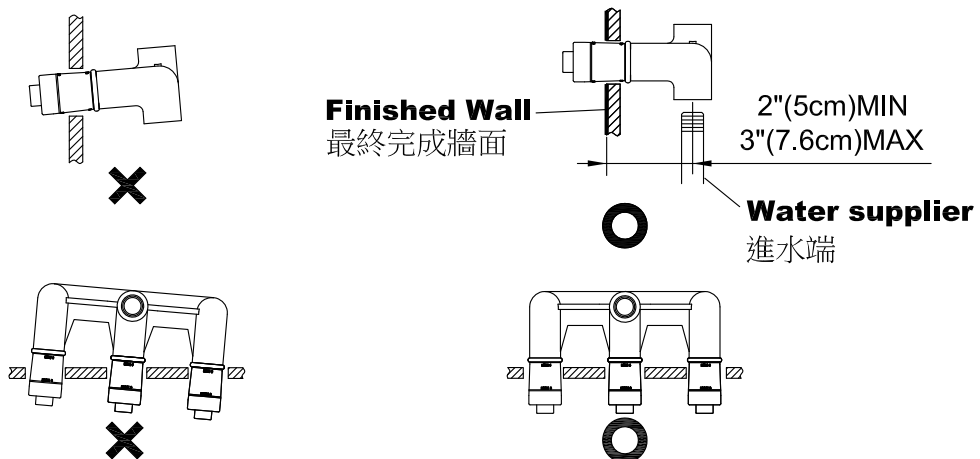

# INSTALLATION INSTRUCTIONS

## 安裝說明

1

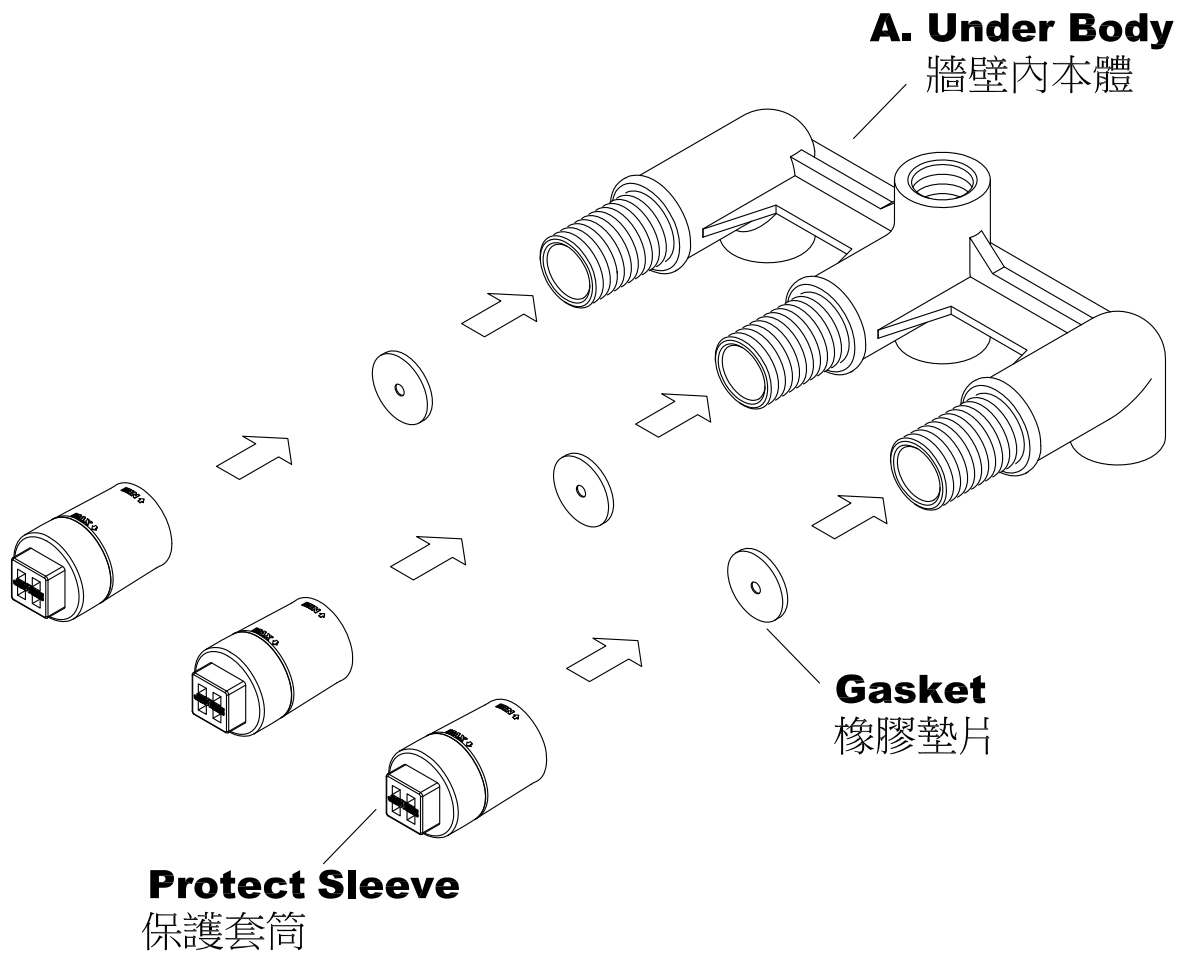

\* Use **Protect Sleeves**, **Gasket** to protect the thread before installation.

使用保護套筒以及橡膠墊片，必須在安裝程序前先套上。

2-1

**Finished Wall**  
最終完成牆面

**Protect Sleeve**  
保護套筒

2"(5cm)MIN  
3"(7.6cm)MAX

**Under Body**  
牆壁內本體

**Water supplier**  
進水端

2-2

**Phillips Screwdriver**  
十字螺絲起子

**Protect Sleeve**  
保護套筒

**Under Body**  
牆壁內本體

**Screws**  
螺絲

\* Connect hot and cold supplies pipes to the **Under Body**, so they are between 2"(5cm) minimum and 3"(7.6cm) maximum from the finished wall, then fixed the **Under Body** in place with **Screws** or **Pipe Clamps**.

安裝牆壁內本體時需預留的牆壁厚度，牆壁內本體與最終完成牆面的距離須保持在最小2"(5cm)到最大3"(7.6cm)之間，此為安裝必要條件，使用螺絲或管夾將牆壁內本體固定。

3

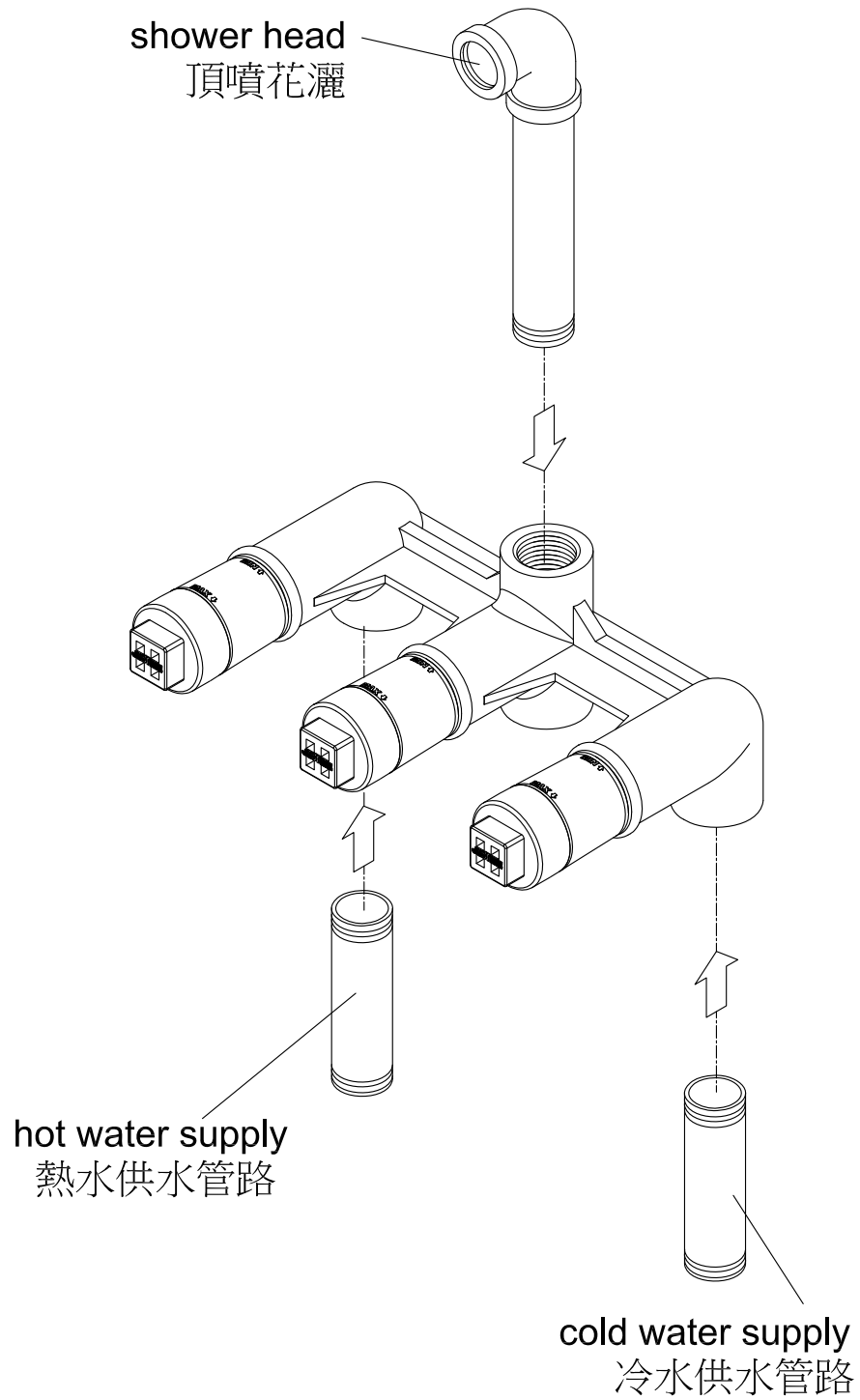

\* Install hot and cold water supply pipes and outlet.

依圖示，安裝冷熱供水管路，與出水管路。

4

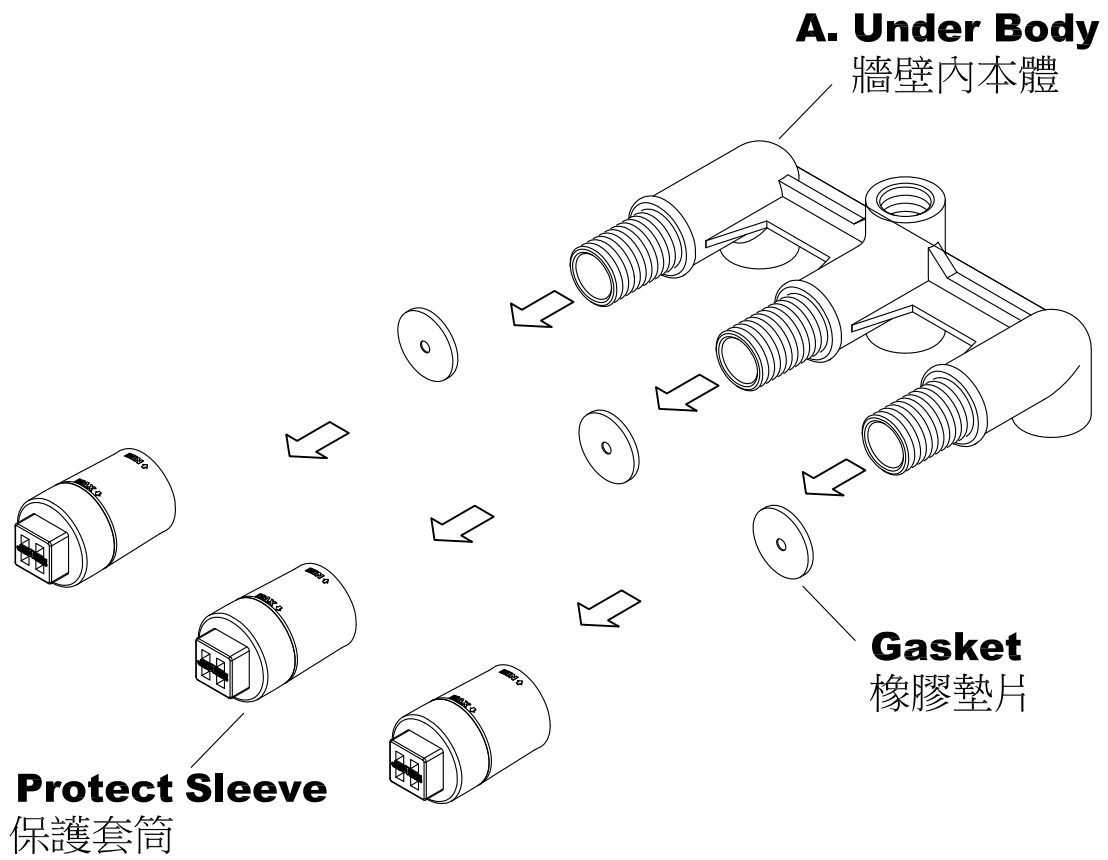

\* Take off **Protect Sleeves**, and **Gasket** before install the **Bath / Shower Mixer**.

使用保護套筒，以及橡膠墊片，必須在安裝浴缸龍頭程序前先取下。



5-1

### B. Bath / Shower Mixer

一切三浴缸龍頭

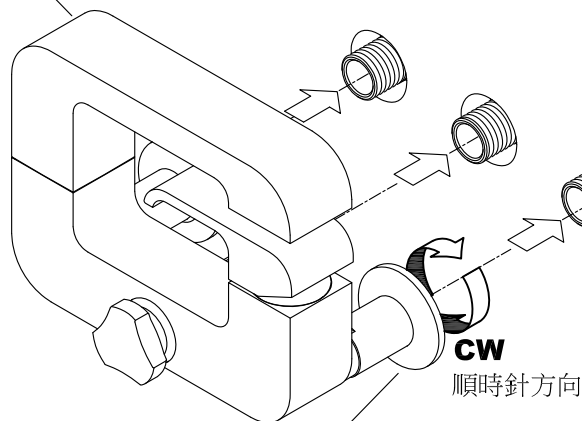

### Finished Wall

最終完成牆面

### Shanks

牙管

0.39"(10mm)MIN  
1.34"(34mm)MAX

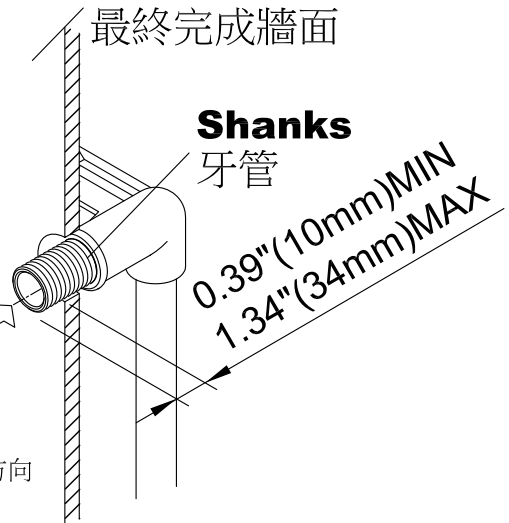

### Flange

法蘭蓋

5-2

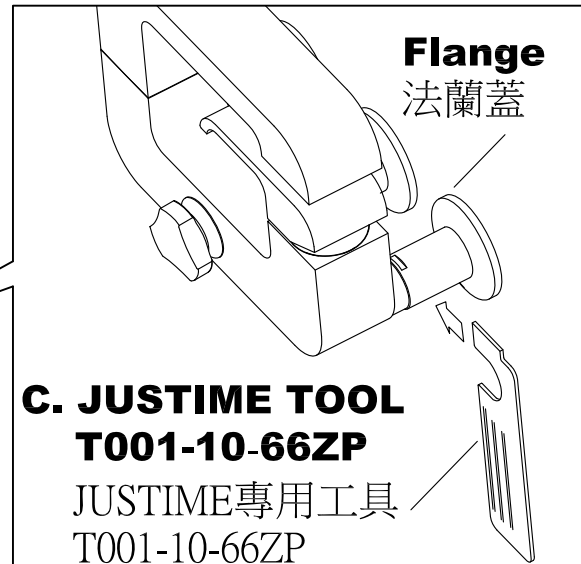
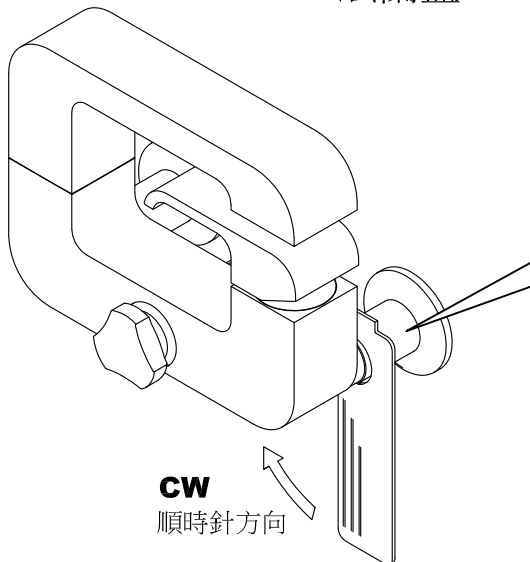

\* For fixing the **Bath / Shower Mixer** Body with the **Shanks**, there should be 10mm~34mm (0.39"~1.34") outside the **Finished Wall**. Then screw the **Flanges** by hands & **JUSTIME Tool T001-10-66ZP** securely against wall.

為了能固定安裝一切三浴缸龍頭，請確保最終牆面外露的牙管長度為10mm~34mm(0.39"~1.34")，然後以雙手搭配JUSTIME專用工具T001-10-66ZP，順時針轉動法蘭蓋直到緊貼牆面。

6

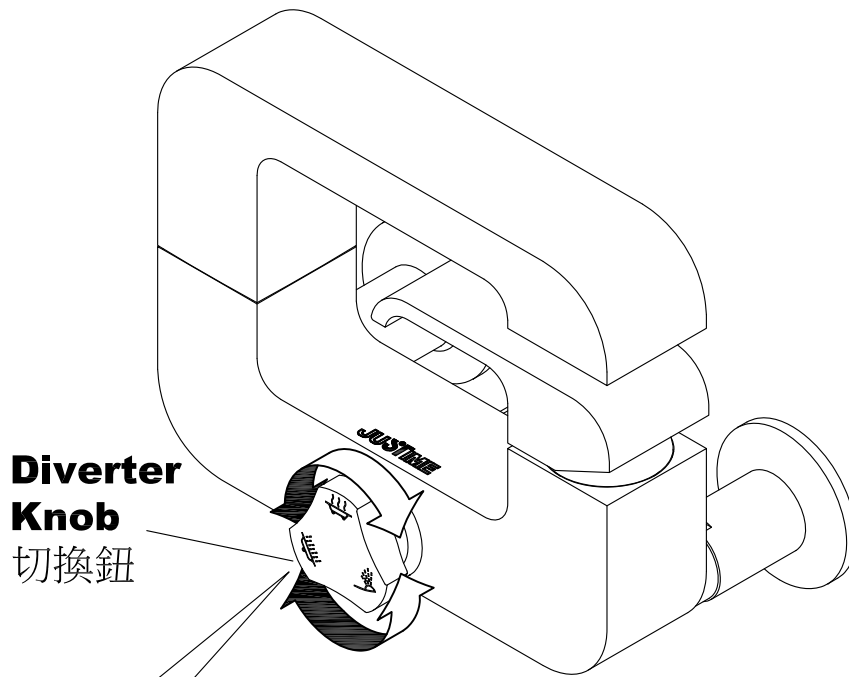

\* On a basis of **JUSTIME LOGO**, there are three ways of outlet for choosing by turning the **Diverter Knob**.

以一切三浴缸龍頭本體上商標為指示標誌，左右旋轉切換鈕使切換鈕上的圖案對準指示標誌，分別可以切換手持花灑，頂噴花灑及出水口三種出水方式。

7-1

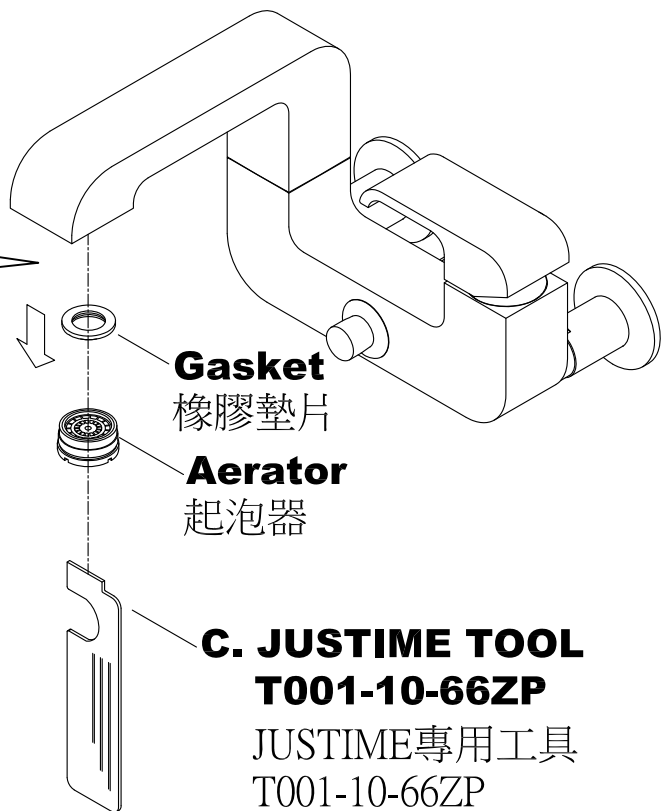
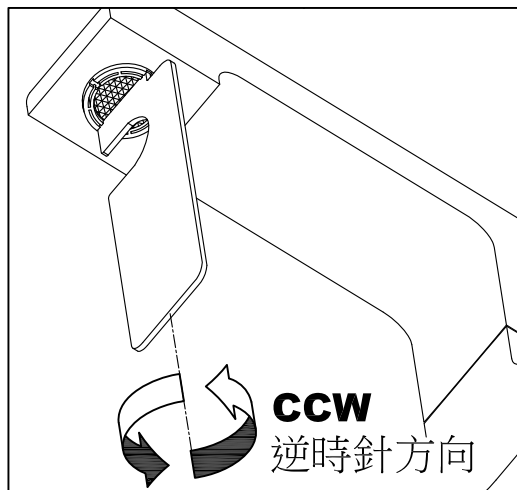

7-2

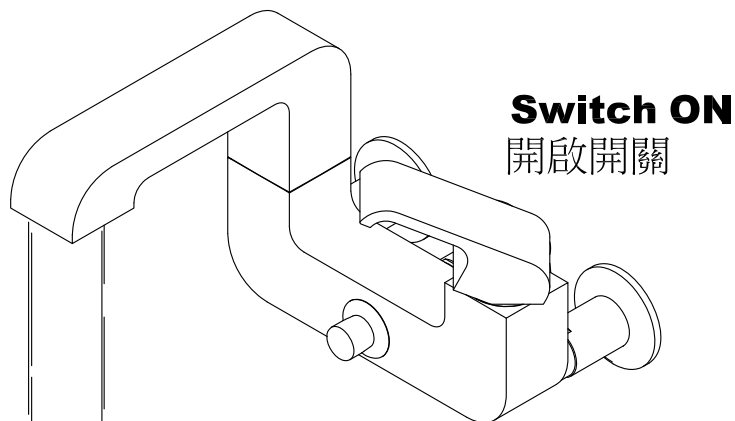

\* Risk of product damage, when finished installation, please disassemble the **Aerator** and **Gasket** counterclockwise with **JUSTIME Tool T001-10-66ZP**, and then fully turn on the hot and cold water valve to run for one minute as first using. After turn off water, please assemble the **Aerator** and **Gasket** with opposite steps as disassembling.

為增加產品使用壽命，建議初次使用時，先使用JUSTIME專用工具T001-10-66ZP以逆時針方向旋轉將起泡器及橡皮墊片取下後，開啟開關持續一分鐘，組合請依拆解時的相反順序組裝，回復原狀即可。

# WARRANTY

Sheng Tai Co., Ltd. offer a three-year warranty on all of the Faucets & Bathroom Accessories from date of purchasing. The warranty covers any defect in material and workmanship during normal residential use. The following conditions of defect are charged for maintaining.

- Damage caused by accident, misuse, improper care and cleaning.
- Improper using or installation.
- Defects because of the external factors, such as erodent environment (ex. Seashore or mineral spring.), animal bites or dead body remains in product etc.
- Defect because of sand or impurity stuck in faucet water way.
- Using water not adhered to the regulations of national standard.
- Deficiency caused by freeze.
- Not showing this warranty card.
- Not filling out in the blank of name of customer, date of purchase, cost of purchase, company of installation (retail store) and stamp on warranty card.
- Sheng Tai Co., Ltd. is not responsible for labor charges, installation, or other incidental or consequential costs.

勝泰衛材股份有限公司提供所有的水龍頭及浴室配件，從購買之日起三年保固。保固範圍包括在一般住宅正常使用的期間，發現產品有任何材質和加工上的瑕疵。如瑕疵有下列情形，將收取維修費用。

- 因意外事故、不當操作使用，不當的保養維護和清洗所造成的損害。
- 不當使用或安裝。
- 外在因素造成產品的瑕疵，如易造成侵蝕的環境（如濱海或溫泉地區）、動物嚙咬或屍體存在於產品內造成的損壞。
- 因砂子或雜質卡住水龍頭水路造成的損壞。
- 沒有依循國家標準的規定使用水源造成的損壞。
- 因冰凍造成的水量不足。
- 未出示此保固卡。
- 未在空白處填寫客戶名稱，購買日期，購買成本，安裝公司（零售商店），及保證卡上未蓋章。
- 勝泰衛材股份有限公司不負責工人費用，安裝，或其他附帶或間接產生的費用。

Customer	Name		Tel	
	Address			
Product	Serial No.		Name	
	Warranty	Three year from date of purchase.		
Purchase place	Store		Tel	
	Address			
Purchase Date				
Purchase Price				

**JUSTIME**  
www.justime.com

**SHENG TAI BRASSWARE CO., LTD.**

No.99 Sec.3 Chang Tsao Rd. Ho Me, Chang Hua, Taiwan  
508 台灣彰化縣和美鎮彰草路3段99號  
TEL: +886-4-7629971~4  
FAX: +886-4-7526980  
E-mail: shengtai@ms10.hinet.net  
Facebook: www.facebook.com/JUSTIME