

# INSTALLATION INSTRUCTIONS

## A. SHOWER HOLDER

花灑掛架組安裝說明

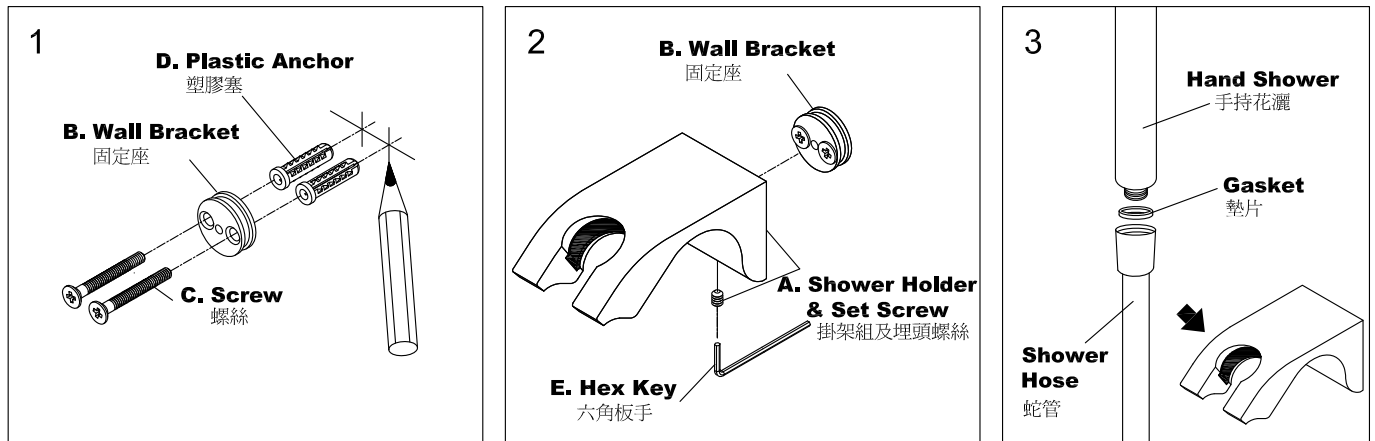

1. Select proper position for product and mark center of mounting hole on wall.  
請先選取預定安裝的位置,並在牆壁上畫上預定鑽孔記號。
2. Using a 6mm drill-bit, drill the holes in marked position to a depth of 4cm. Insert the **Plastic Anchors** into the holes on the wall, put the **Screw(s)** through the **Wall Bracket**, then screw into the **Plastic Anchors**.  
當安裝在水泥牆,使用1/4英寸鑽頭,鑽孔深度4公分,填入塑膠塞並使之齊平於牆面,將固定座以螺絲鎖緊在牆上。
3. Use the **Hex Key** to loosen the **Set Screw** in the **Shower Holder**. Slide the **Shower Holder** over the **Wall Bracket** and tighten **Set Screw** ensuring the orientation of the **Shower Holder** is correct as fig.2 shown.  
用隨附六角板手先鬆開掛架下方的埋頭螺絲,使固定座能順利套進掛架組後,再鎖緊下方的埋頭螺絲,完成安裝程序如圖示2。

## FIXING CONTENTS

組配件內容

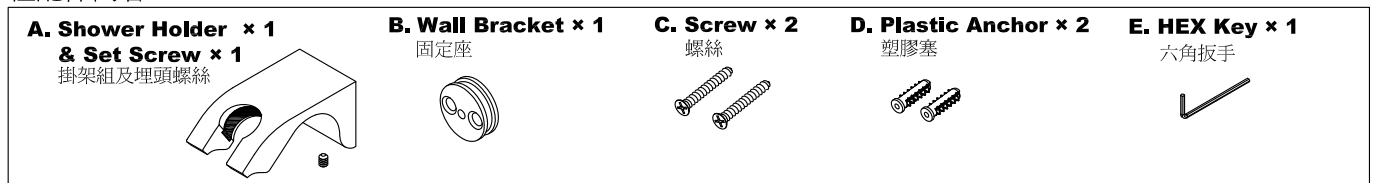

## B. HAND SHOWERS / SHOWER HOSE

手持花灑 / 花灑蛇管

1. Connect **Hand Shower** With **Hose**, and then place the **Hand Shower** on the Holder as fig.3 shown.  
再將所選購的手持花灑接上蛇管,插於掛架內,如圖示3。

WALL BRACKETS COULD COLLOCATE WITH VARIOUS JUSTIME HAND SHOWERS.

可搭配巧時代(JUSTIME)其他造型手持花灑

