

Sensor Basin Faucet (Cold only)

6875-S5-80CP

INTRODUCTION:

Taking simple letter Y as the design concept, the faucet combines special design concepts with practicality. It works fine with washing machine, and fits well in gardens and outdoor spaces. There is no need to install the pipe clamps or other tools to connect the water hose. The overall shape is neat and tidy, making the overall environment more beautiful.



DESCRIPTION:

1. Infrared Sensor Automatic Detection
2. Safety Guard: Valve off if water flowing over 60sec.
3. Automatically detect the environment, adjust the sensor, and have anti-interference function.
4. Inner filter prevent the blockage of sensor valve.
5. Power Source: Alkaline Battery AA x 4, DC6V(1.5V x 4)
6. Battery life test: about 300,000 alkaline batteries; about 100,000 carbon zinc batteries.
7. Flush Mode: Water start flowing if valid sensing around 0.5sec~1.0sec
8. Low power prompt: Red indicator light will be flashed for prompting battery replacement.
9. The faucet valve can stand the pressure from 0.5 to 6 kgf/cm²
10. Brass with Chrome plated meets ASTM-SC2 standard; 3 years guarantee.

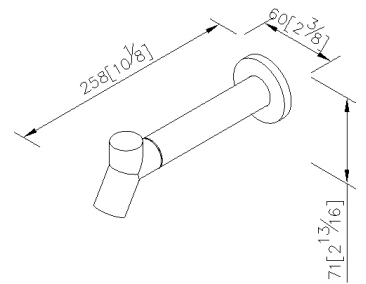

unit:mm[inch]

Certification:

Fixing Kits:

- 1. Hex Key 2.0mm*1
- Set Screw*4
- Plastic Anchors*4
- Clip*1

AWARD: