

INSTALLATION INSTRUCTIONS

SPRAYER

洗滌器安裝說明

PATENT NUMBER:
專利號碼:
000744206-0001
568.440 S
D120296
ZL200730157476.7

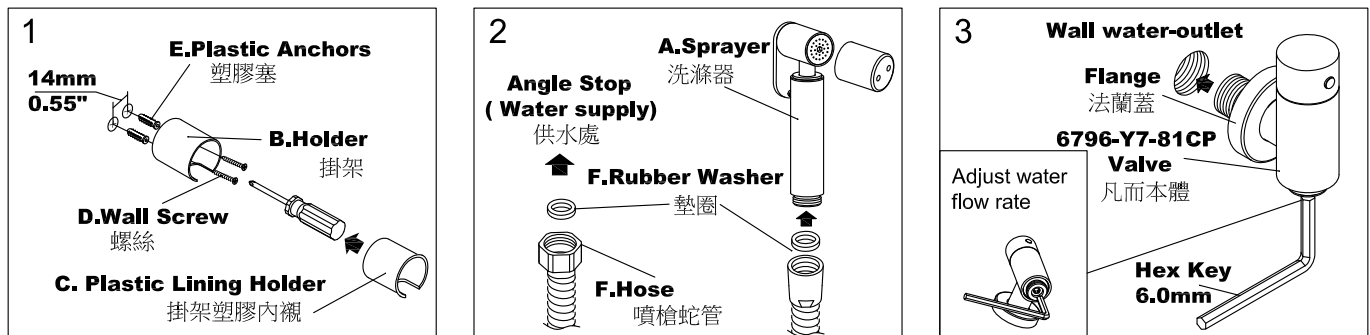

1. Drill and insert **Plastic Anchors** flush with wall at proper position, screw **Wall Screws** and fix **Holder** on the wall then insert **Plastic Lining Holder** into **Holder**.
在牆壁上鑽孔並嵌入塑膠塞使之齊平於牆面，利用螺絲將掛架固定於牆上然後裝入掛架塑膠內襯。
2. Insert **Rubber Washer** into **Hose**, and then Connect **Hose** with **Angle Stop (Water Supply)** and **Sprayer**.
將墊圈裝入噴槍蛇管並用噴槍蛇管連接供水處1/2G及噴槍。
3. Installation of **Valve**: Pierce the thread-end of Valve through **Flange**, and then apply some pipe compound or thread sealant tape to the thread end and screw the **Valve** into **Wall water-outlet**.
** Water flow rate of **Valve** (6796-Y7-81CP) could be adjusted inside the outlet by **Hex key** as the figure 3 shown.
閥體/凡而安裝方式：將法蘭蓋從凡而本體螺紋的末端裝入，然後在螺紋塗上膠合劑或是纏上止洩帶並鎖入牆壁的出水口
** 6796-Y7-81CP 有加水壓調整閥的凡而可使用六角扳手從凡而底部的出水口調節出水量。

MAINTAINING

維護方式

1. For cleaning the plastic meshes cover, please using 4mm **Hex Key** to remove the plastic meshes cover only as attached figure shown.
清潔噴灑頭塑膠蓋，如圖指示，使用 4mm六角扳手開啟或裝置噴灑頭塑膠蓋。

CAUTION

注意事項



1. Do not remove inner metal seal. Reassembly the inner metal seal parts may cause the sprayer to lose function or damage the sprayer.
請勿取出內部金屬止水零件。重新組裝內部金屬止水零件，可能導致噴槍功能失效或嚴重損壞噴槍。
2. Do not overtighten the plastic meshes cover when reassembly, or may damage the hex hole of plastic meshes cover.
重新裝置噴灑頭塑膠蓋時，請勿過度鎖緊，損壞塑膠六角內孔。
3. Please run the water to clean the pipe before installation.
安裝洗滌器前須先將水中雜質排乾淨。
4. Operate the Sprayer to make sure it could work smoothly after installation. Please try the Maintaining if it get stuck.
安裝後須先按壓洗滌器幾次讓出水順暢，如有雜質卡住參考維護方式。

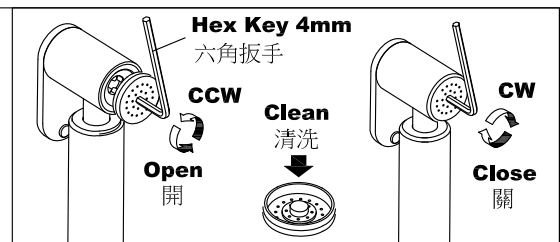

FIXING CONTENTS

組配件內容

