

Drawer Handle  
6781-K0-80CP

**INTRODUCTION:**

JUSTIME Ether accessories benefit users with a combination of excellent quality, precise workmanship, innovation and beautiful designs. The overall design concept is based on the idea of ether - an unlimited medium filling all space. Smooth lines and soft characteristics signify the aura of ether, which moves like an ever-present ocean current. The unique design of ETHER breaks traditional ideals and established shapes, bringing this knob to a new artistic level.



**DESCRIPTION:**

- 1.Brass of forging body meets JIS 3771 standard
- 2.Premium metal construction for durability
- 3.Justime finishes resist corrosion and tarnish
- 4.Finish meets the standard of ASTM-SC2
- 5.Curved shape and smooth surface help to reduce water stains
- 6.Coordinates with other products in Ether collection

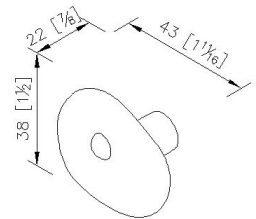

unit: mm[inch]

**Certification:**

**Fixing Kits:**

- 1.N/A

**AWARD:**

