

INSTALLATION INSTRUCTIONS

Countertop Soap Dispenser (Theft-Proof Type)

檯面式擠皂器(防竊)安裝說明

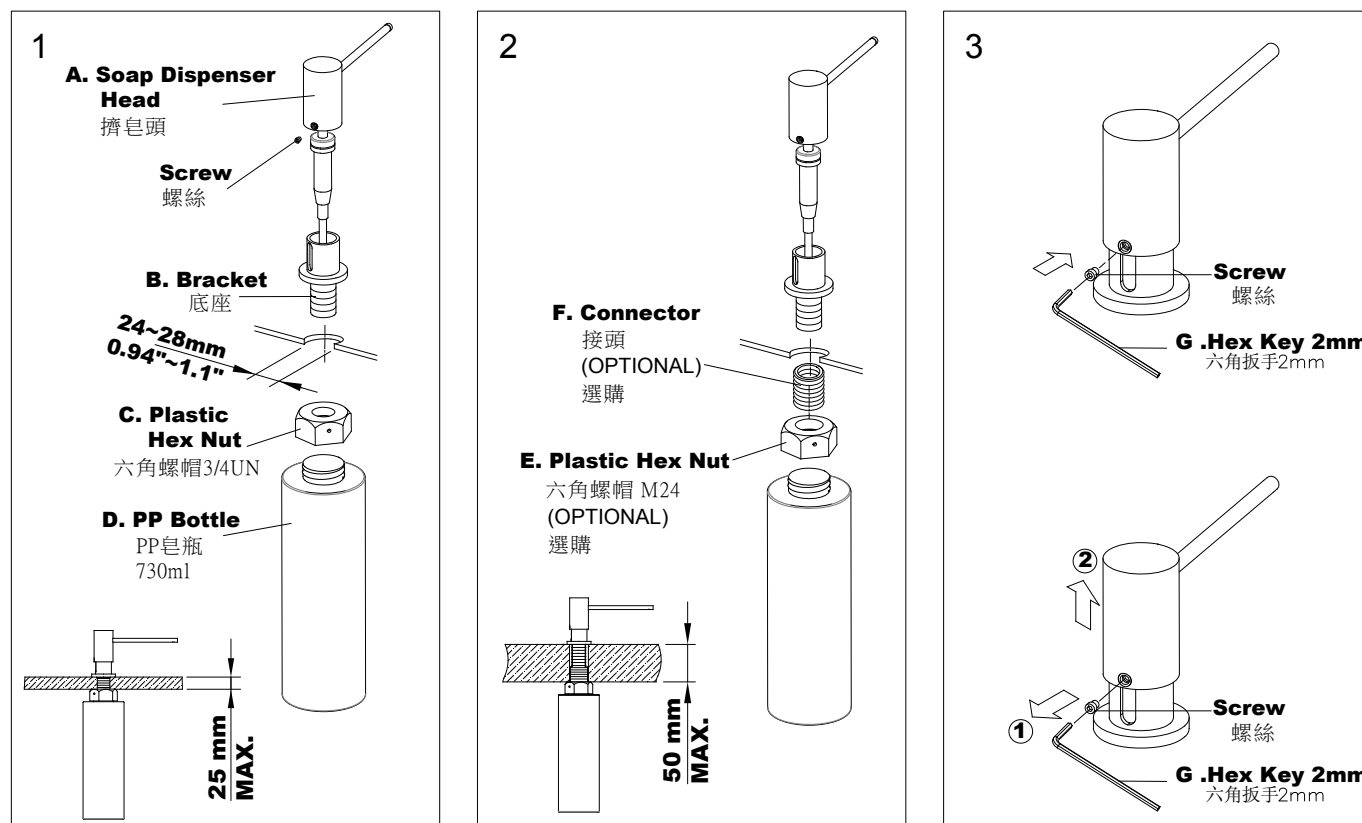

⚠ NOTICE : Mark the proper position and drill a hole with 24~28mm (0.94"~1.1") diameter as the Fig. 1 shows.

注意：請先選取預定安裝的位置,先確認鑽孔的位置,在檯面上鑽孔24~28 mm(0.94"~1.1")如圖示1

1. Place the **Bracket** through the hole and tighten **Plastic Hex Nut** to fix it; fill **PP Bottle** with liquid soap and thread into the **Plastic Hex Nut** till hand-tight; insert the **Soap Dispenser Head** in the **Bracket**.

將底座置入檯面孔內，鎖入六角螺帽；將PP皂瓶填入皂液後鎖到六角螺帽內，再放入擠皂頭。

2. Users could purchase the optional **Plastic Hex Nut (M24)** and **Connector** to extend the shank of Bracket for installing on the thicker deck.

為防止檯面厚薄不一,可能發生擠皂器底座不夠長無法組裝,可以選配2多增加一個接頭和六角螺帽,便可增加長度。

3. Aim the **screw** hole of **Soap Dispenser Head** to the groove of **Bracket**, and then fix the **Set Screw** with **Hex Key**. Loosen the Set Screw with Hex Key to remove the Soap Dispenser Head

用六角扳手將螺絲鎖入擠皂頭。 ** 注意螺絲孔須對準底座溝處**；若用六角扳手將螺絲鬆開即可拿出擠皂頭。

FIXING CONTENTS

組配件內容

