

Still One

Tub Spout 6770-9W-85S1

INTRODUCTION:

Inspired by the main design conception of "Less is More" Still One used brief lines and a simple model to integrate the practicality and elegance with the concise design style. It also fits for the general kitchen arrangement- small and saving space. The product is made of lead-free brass or stainless steel, which both meet NSF Standard.



DESCRIPTION:

1. Stainless steel body meets SUS 304 standard.
2. Premium metal construction for durability.
3. Justime finishes resist corrosion and tarnish.
4. The faucet should be used at the water pressure from 1 to 6 kg/cm².
5. G1/2 inlet.
6. Easy to install and disassemble for replace the components.

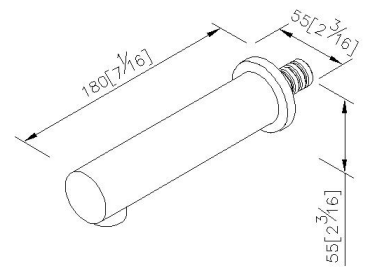

unit: mm[inch]

Certification:

Fixing Kits:

1. N/A

AWARD: