

Candle

Hand Shower Holder W/Supply Elbow 6757-DC-81CP

INTRODUCTION:

This series has a nice cylindrical body design, which shows a balanced and symmetrical beauty.



DESCRIPTION:

- 1.Brass of forging body meets JIS 3771 standard.
- 2.Premium metal construction for durability.
- 3.Justime finishes resist corrosion and tarnish.
- 4.Finish meets the standard of ASTM-SC2.
- 5.Thread: G 1/2.

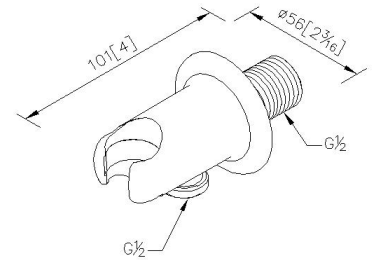

unit: mm[inch]

Certifictaion:

Fixing Kits:

N/A

AWARD: