

INSTALLATION INSTRUCTIONS

6515安裝說明

- Select proper position for installation, paste this **Template** on wall, make sure the drilling holes on the same level, and then drill 10mm holes for **Bracket** to 70mm depth.
請先選取預定安裝的位置，於牆壁貼上鑽孔定位紙，並確認鑽孔位置是在同水平線上後，支撐架使用10mm鑽頭鑽孔。
- Remove **Template**, and fix **Gasket** and **Bracket** with the **Anchor Bolts (Bracket)**. Insert **Anchor Bolts (Bracket)** with hammer to the hole end and tighten **Anchor Bolts (Bracket)** with Adjustable Wrench.
將鑽孔定位紙取下，並安裝支撐架至牆面上，膨脹螺絲(支撐架用)穿過支撐架及墊片並敲至洞孔底，再使用活動或開口扳手鎖緊螺絲，固定住支撐架。
- Place the **basin** on the **Bracket**, mark the drilling positions, remove the **basin**, and then drill 12.7mm($\frac{1}{2}$ ") holes for **basin** to 70mm depth. Insert the **Anchor Bolt (Basin)** with hammer to the hole end, remove **Nut, Rubber Gasket** and one **Washer** from bolts. Fix the **Basin** with **Rubber Gasket, Washer**, and **Nut** in sequence, and then tighten **Nut** with Adjustable Wrench to complete the installation.
將臉盆放置在支撐架上，然後劃記安裝記號後，移開臉盆，使用12.7mm($\frac{1}{2}$ ")鑽頭鑽孔。將膨脹螺絲(臉盆用)敲至洞孔底，只取出螺帽、橡皮墊圈和一片華司。再將臉盆裝上，依序套入橡皮墊圈、華司和螺帽，再使用活動或開口扳手鎖緊螺帽，固定住臉盆。

6515
SERIES:

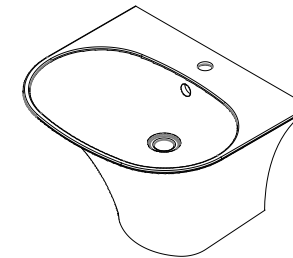

6515-F1(附墊片)

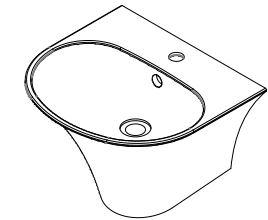

6515-F2

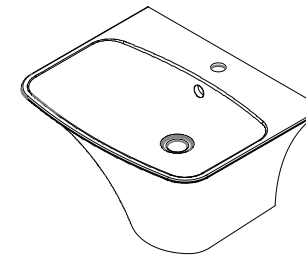

6515-F3(附墊片)

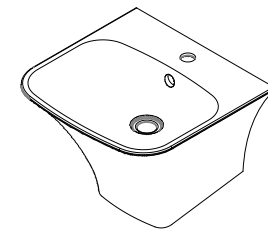

6515-F2

